

		Marzell Camenzind Eggen 6442 Gersau www.holzbau-camenzind.ch		Tel/Fax 041 828 17 44 Natel 079 750 88 50 holzbaucama@bluewin.ch Copyright by Zälli	
Bauherr :		Innenwand DG IW2-06 und IW2-06/2		Anmerkungen : A 2	
Masstab : 1 : 20	Zeichner : Zälli	Datum : 11.10.2017	Revidiert :	Revidiert :	Revidiert :

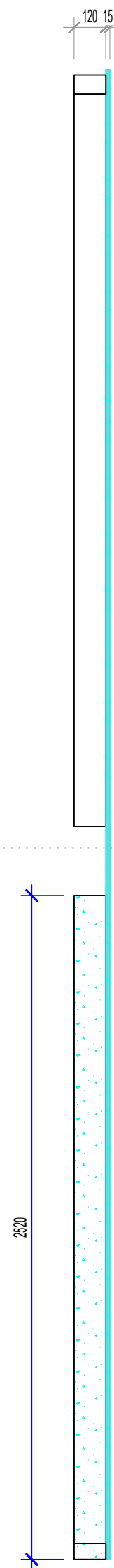

15,120

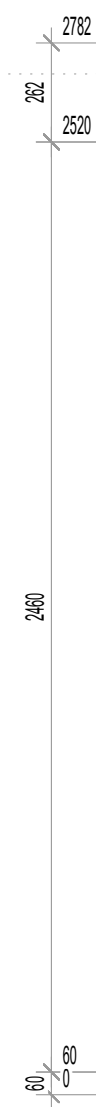
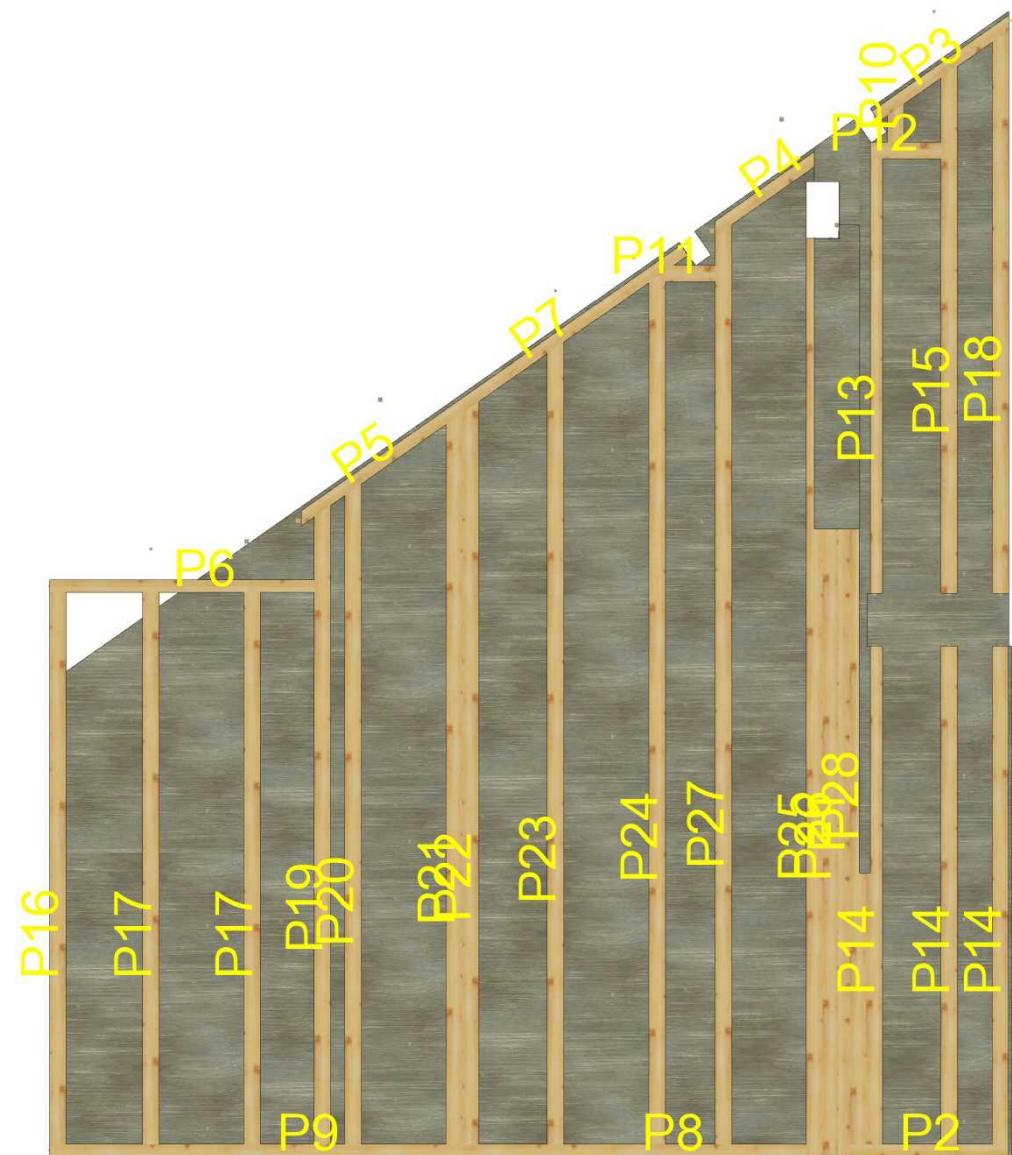